



Conference Planner

BANFF
CENTRE
FOR ARTS AND
CREATIVITY

We recognize, with deep respect and gratitude, our home on the side of Sacred Buffalo Guardian Mountain.

In the spirit of respect and truth, we honour and acknowledge the Banff area, known as “Minirhpa” (translated in Stoney Nakoda as “the waterfalls”) and the Treaty 7 territory and oral practices of the Îyârhe Nakoda (Stoney Nakoda) – comprised of the Bearspaw, Chiniki, and Goodstoney Nations – as well as the Tsuut’ina First Nation and the Blackfoot Confederacy comprised of the Siksika, Piikani, and Kainai. We acknowledge that this territory is home to the Shuswap Nations, Ktunaxa Nations, and Metis Nation of Alberta, District 4. We acknowledge all Nations who live, work, and play here, help us steward this land, and honour and celebrate this place.



Home to



Contents

Overview	1
Meet + Connect	2
Meeting Spaces	2
Kinnear Centre for Creativity and Innovation	3
Max Bell Building	8
Professional Development Centre	12
Theatre Complex	15
Innovative Programming	17
Conference Planning	19
Stay + Dine	20
Banff Centre Hotel	20
Dining	20
Sally Borden Fitness and Recreation Centre	22
Arts + Culture	23
The Destination	24
General Information	26



VISTAS

VISTAS

Banff Centre is creativity and ideas.

We are a full-service conference and hotel venue located within Canada's leading arts and cultural organization based in the Canadian Rockies. We specialize in convening impactful meetings.

From conferences to banquets, trade shows and retreats, we inspire leaders, executives and all attendees to make their unique contribution to society. Banff Centre's spectacular setting and innovative programming unlock human potential.

Our home on the side of Sleeping Buffalo Mountain, in Treaty 7 territory is a sacred place for Indigenous people. For generations, Indigenous people gathered and held celebrations here, a tradition that continues today. Banff Centre is committed to Truth and Reconciliation by creating a dialogue between Indigenous and non-Indigenous Canadians.

Corporate Social Responsibility

Banff Centre is not-for-profit with all revenue from conferences underwriting scholarships for artists and leaders. Furthermore, located within Banff National Park, UNESCO World Heritage, we value our pristine environment. From regionally and sustainably sourced food to waste reduction and recycling practices, we ensure that all meeting-related activities and operations have a minimal environmental impact.

> 65 years
of the history of conference
and meetings at Banff Centre

> 600
conferences and
meetings annually

> 20,000
delegates every year

> 60
exceptional meeting spaces

> 72,000 ft² / 6,690 m²
of meeting facilities

387
hotel rooms

3
restaurants

Meet + Connect

Meeting Spaces

Banff Centre combines sustainable modern facilities and breathtaking mountain vistas to create compelling conference experiences, which engage a wide variety of attendees.

72,000 ft² / 6,690 m²
of meeting facilities

> 60
exceptional meeting spaces

Groups of
up to 650

Member of the International
Association of Conference
Centres (IACC)





Kinnear Centre for Creativity and Innovation

Kinnear Centre was designed to create an environment that encourages interaction and engagement among attendees. The sustainable and sophisticated building design provides an abundance of natural light along with breathtaking vistas to make your meeting spectacular.

Total space:
21,000 ft² / 1,950 m²

Largest space:
5,920 ft² / 550 m²

17
fully-equipped meetings rooms

Groups
up to 400

Perfect fit:

- Keynote sessions
- Banquets and receptions
- Tradeshows
- Breakout sessions



Kinnear Centre—Ground Floor

Room Name and/or Number	Classroom (2/table)	Classroom (3/table)	Theatre	Rounds of 6	Rounds of 8	Rounds of 10	U-Shape	Reception	Dimensions (metres) L x W	Dimensions (feet) L x W	Area (metres ²)	Area (feet ²)	Ceiling Height (metres)	Ceiling Height (feet)
Cenovus Great Hall Room 101	48	72	126	54	72	90	39	175	12.5 x 12.5	41 x 41	156.25	1,681	3.95	13'
Cenovus Great Hall Room 103	80	114	196	102	136	170	51	266	12.5 x 19	41 x 62.4	237.5	2,558	3.95	13'
Cenovus Great Hall Room 105	48	72	126	54	72	90	39	175	12.5 x 12.5	41 x 41	156.25	1,681	3.95	13'
Cenovus Great Hall Rooms 101 & 103 Combined	130	195	308	138	184	230	162	442	12.5 x 31.5	41 x 103.4	393.75	4,239	3.95	13'
Cenovus Great Hall Rooms 103 & 105 Combined	130	195	308	138	184	230	162	442	12.5 x 31.5	41 x 103.4	393.75	4,239	3.95	13'
Cenovus Great Hall 101, 103 & 105 Combined	180	270	428	210	280	350		617	12.5 x 44	41 x 144.4	550	5,920	3.95	13'

Please Note: All capacity numbers are based on basic AV set-ups.
All room set-ups based on using banquet chairs, except where indicated.

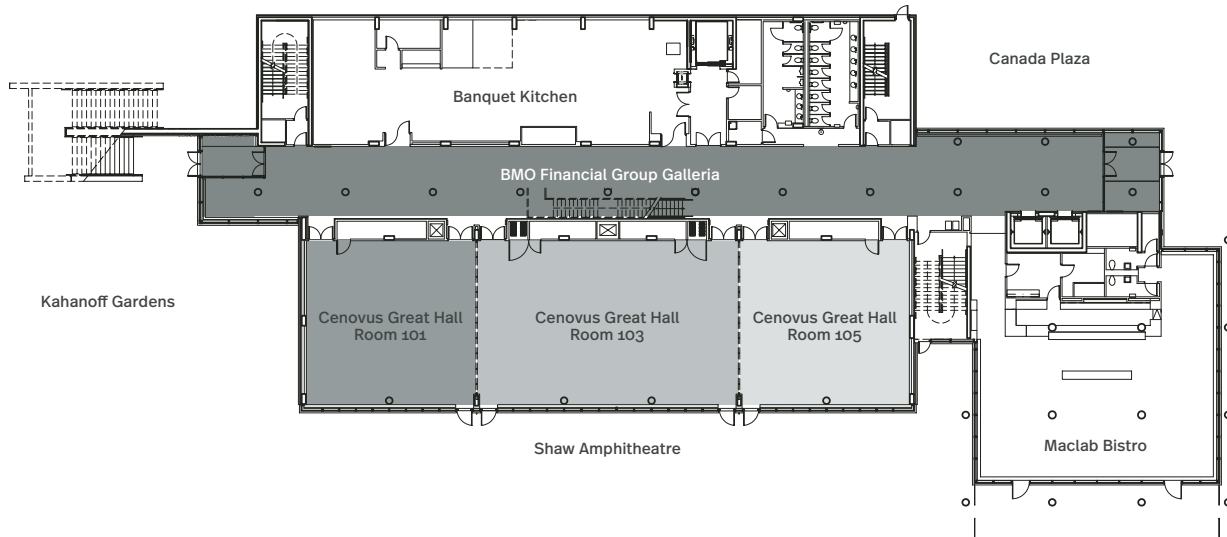

Kinnear Centre–Second Floor

Room Name and/or Number	Classroom (2/table)	Classroom (3/table)	Theatre	Rounds of 6	Rounds of 8	Rounds of 10	U-Shape	Reception	Dimensions (metres) L x W	Dimensions (feet) L x W	Area (metres ²)	Area (feet ²)	Ceiling Height (metres)	Ceiling Height (feet)
Room 201	48	72	126	54	72	90	39	175	12.5 x 12.5	41 x 41	156.25	1,681	3.3	10'10"
Room 203	80	114	196	102	136	170	51	266	12.5 x 19	41 x 62.4	237.5	2,558	3.3	10'10"
Room 205	48	72	126	54	72	90	39	175	12.5 x 12.5	41 x 41	156.25	1,681	3.3	10'10"
Rooms 201 & 203 Combined	130	195	308	138	184	230		442	12.5 x 31.5	41 x 103.4	393.75	4,239	3.3	10'10"
Rooms 203 & 205 Combined	130	195	308	138	184	230		442	12.5 x 31.5	41 x 103.4	393.75	4,239	3.3	10'10"
Rooms 201, 203 & 205 Combined	152	228	420	198	264	330		617	12.5 x 44	41 x 144.4	550	5,920	3.3	10'10"
Gibson Energy Room 202	16	24	32	12	16	20	21		7.8 x 4.8	25.7 x 15.9	37.44	408	3.35	11'
Encana Corporation Room 204	12	18	32	12	16	20	21		7.2 x 4.8	23.8 x 15.9	34.56	378	3.35	11
Calgary Flames Foundation Room 206	16	24	36	18	24	30	24		8.8 x 5.1	28.11 x 16.9	44.88	475	3.35	11
Cenovus Energy Room 208	12	18	32	12	16	20	21		7.2 x 4.8	23.8 x 15.9	34.56	378	3.35	11
Bird Construction Company Learning Space Room 210	12	18	32	12	16	20	21		7.8 x 4.8	25.7 x 15.9	37.44	408	3.35	11

Please Note: All capacity numbers are based on basic AV set-ups.
All room set-ups based on using banquet chairs, except where indicated.

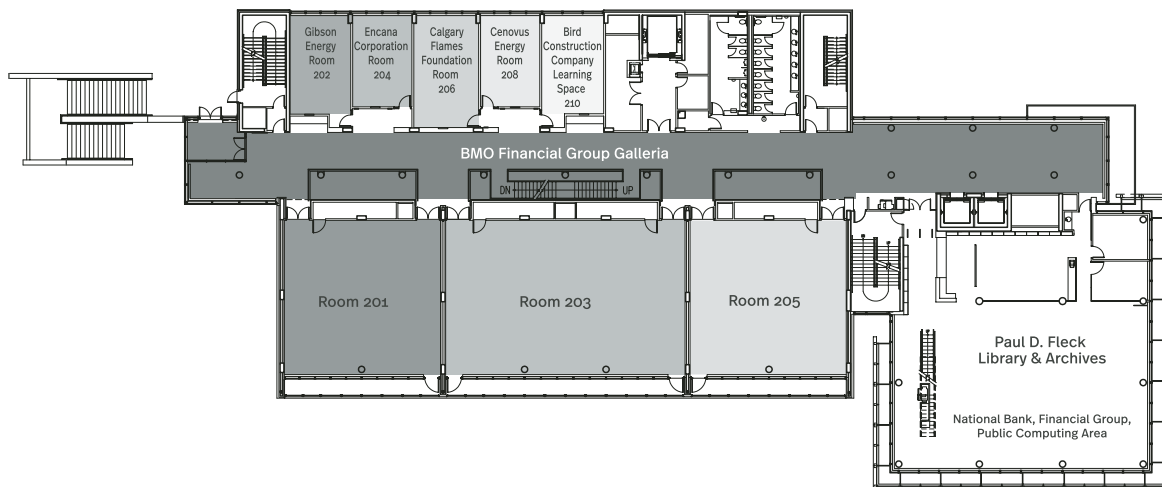

Kinnear Centre—Third Floor

Room Name and/or Number	Classroom (2/table)	Classroom (3/table)	Theatre	Rounds of 6	Rounds of 8	Rounds of 10	U-Shape	Reception	Dimensions (metres) L x W	Dimensions (feet) L x W	Area (metres ²)	Area (feet ²)	Ceiling Height (metres)	Ceiling Height (feet)
Room 301	48	72	126	54	72	90	39	175	12.5 x 12.5	41 x 41	156.25	1,681	3.6	11'10"
Room 303	80	114	196	102	136	170	51	266	12.5 x 19	41 x 62.4	237.5	2,558	3.6	11'10"
Pengrowth Corporation Room 305	48	72	126	54	72	90	39	175	12.5 x 12.5	41 x 41	156.25	1,681	3.6	11'10"
Room 302	16	24	32	12	16	20	21		7.8 x 4.8	25.7 x 15.9	37.44	408	3.6	11'10"
Xerox Canada Ltd. Room 304	12	18	32	12	16	20	21		7.2 x 4.8	23.8 x 15.9	34.56	378	3.6	11'10"
Room 306	16	24	36	18	24	30	24		8.8 x 5.1	28.11 x 16.9	44.88	475	3.6	11'10"
Room 308	12	18	32	12	16	20	21		7.2 x 4.8	23.8 x 15.9	34.56	378	3.6	11'10"
Room 310	12	18	32	12	16	20	21		7.8 x 4.8	25.7 x 15.9	37.44	408	3.6	11'10"

Please Note: All capacity numbers are based on basic AV set-ups.
All room set-ups based on using banquet chairs, except where indicated.

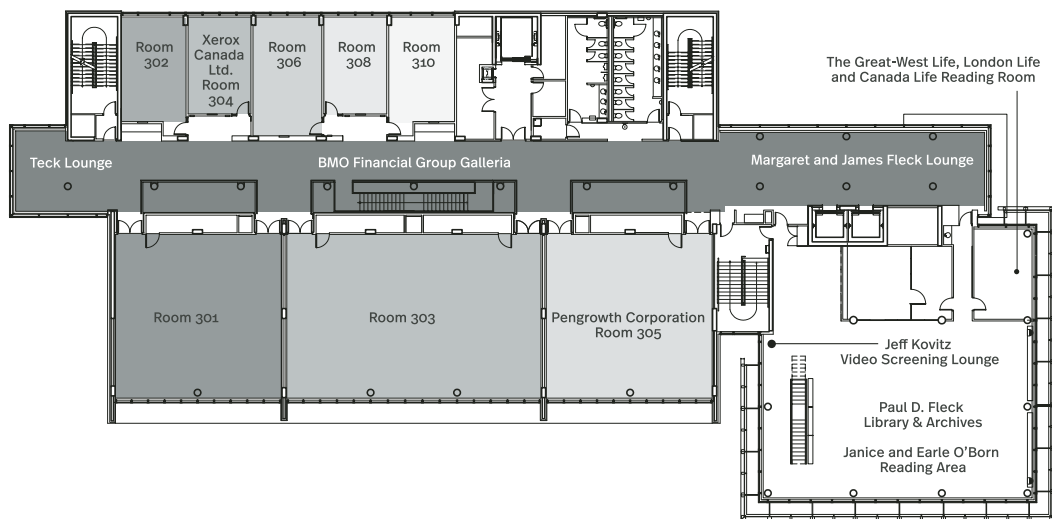



“We held our conference in the Kinnear Centre for the first time this year. The service from start to finish was excellent. Quality of food, staff and facilities were outstanding. We intend to come back again.”

Glyn J. Smith, Administrator
Pain Society of Alberta

Max Bell Building

The Max Bell Building is surrounded by forest, for guests to feel truly immersed in the tranquility of our serene environment. It features a tiered 340-seat auditorium engineered for acoustic excellence and equipped with a 15-foot screen, dimmer lighting, a sound system, and projection booth. The building also includes 14 meeting rooms of varying capacities. A large central foyer is ideal for conference registration, receptions, or displays.



Total space:
15,000 ft² / 1,390 m²

Main auditorium for
340 participants

14
fully-equipped meeting spaces

Perfect fit:

- Conferences
- Lectures
- Breakouts sessions
- Trade shows



Max Bell Building

Room Name and/or Number	Classroom (2/table)	Classroom (3/table)	Theatre	Rounds of 6	Rounds of 8	Rounds of 10	U-Shape	Boardroom	Hollow Square	Reception	Dimensions (metres) L x W	Dimensions (feet) L x W	Area (metres ²)	Area (feet ²)	Ceiling Height (metres)	Ceiling Height (feet)
Auditorium* *tiered, fixed seating	140		340								20.1 x 20.7	66 x 68	416	4,488	4.2	13' 8"
Cenovus Energy Foyer										125	Irregular	Irregular	187	1,078	2.7	9'
The Elder Tom Crane Bear Room	34	51	80	48	64	80	36		42	100	Irregular	Irregular	69	744	2.6	8' 9"
Cenovus Energy Foyer & The Elder Tom Crane Bear Room Combined										225	Irregular	Irregular	256	1,822	2.6	8' 9"
MB151	6	9	12	6	8	10	9	9			5.5 x 4.3	18 x 24	24	252	2.6	8' 9"
MB152	4	6	12					6			3.7 x 5.8	12 x 19	21	228	2.6	8' 9"
MB153	4	6	12	6	8	10		12			3.7 x 5.8	12 x 19	21	228	2.6	8' 9"
MB154	4	6	12	6	8	10	9	9			4.7 x 3.7	15 x 12	17	180	2.6	8' 9"
MB155	6	9	16					12			6 x 3.6	20 x 12	22	240	2.6	8' 9"
MB156	16	24	40	18	24	30	18	18	24		7 x 7.3	23 x 24	51	552	2.6	8' 9"
MB157	4	6	18	6	8	10	9	9			5.5 x 3.6	18.5 x 12	20	222	2.6	8' 9"
MB251	32	48	85	36	48	60	33	30	42		8.7 x 11.6	29 x 38	110	1,102	3	9' 10"
Chevron Canada Limited Room MB252	56	84	126	72	96	120	45	36	60		12.2 x 15.5	40 x 51	189	2,040	2.9	9' 8"
MB253	50	75	98	42	56	70	36	30	42		9.8 x 11.9	32 x 39	117	1,248	3	9' 10"

Please Note: All capacity numbers are based on basic AV set-ups.

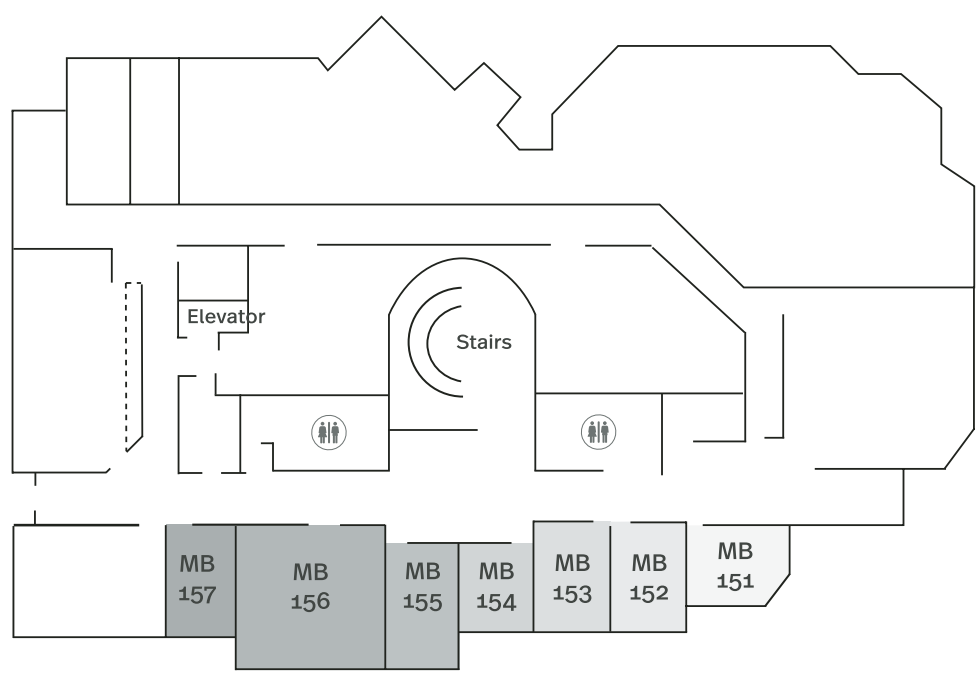
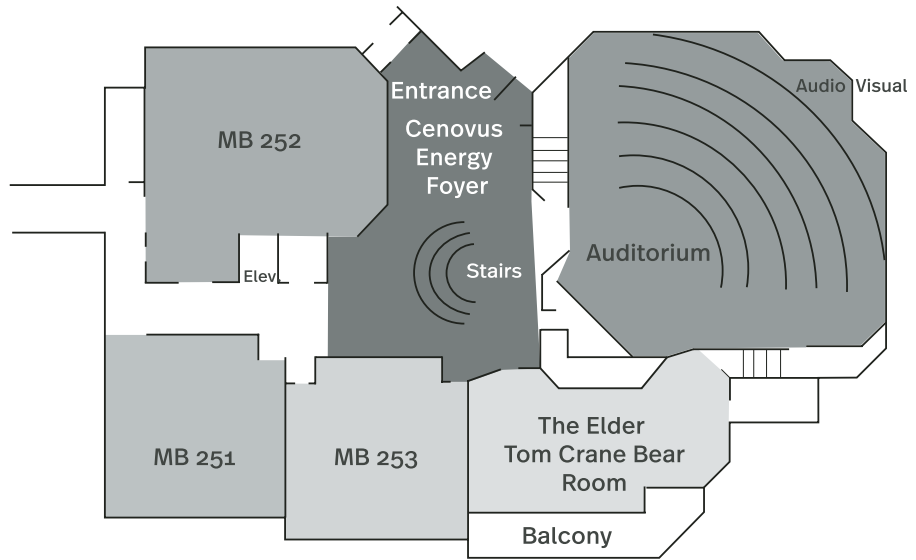



“[Banff Centre] is an exceptional place... The organization is seamless and environment is wonderful. Being able to spend extended time with international researchers is invaluable. It is exactly the kind of interactivity needed to achieve sustained progress.”

Daniel Waldram, London UK

Professional Development Centre

The Professional Development Centre features timber beams, high vaulted ceilings, and large floor-to-ceiling windows that welcome in natural light and immerse your attendees into our mountain environment.



Photo courtesy of Banff Centre.

Total space:
4100 ft² / 380 m²

3
fully-equipped meeting spaces

Groups
up to 100

Perfect fit:

- Board meetings
- Receptions
- Informal gatherings and networking

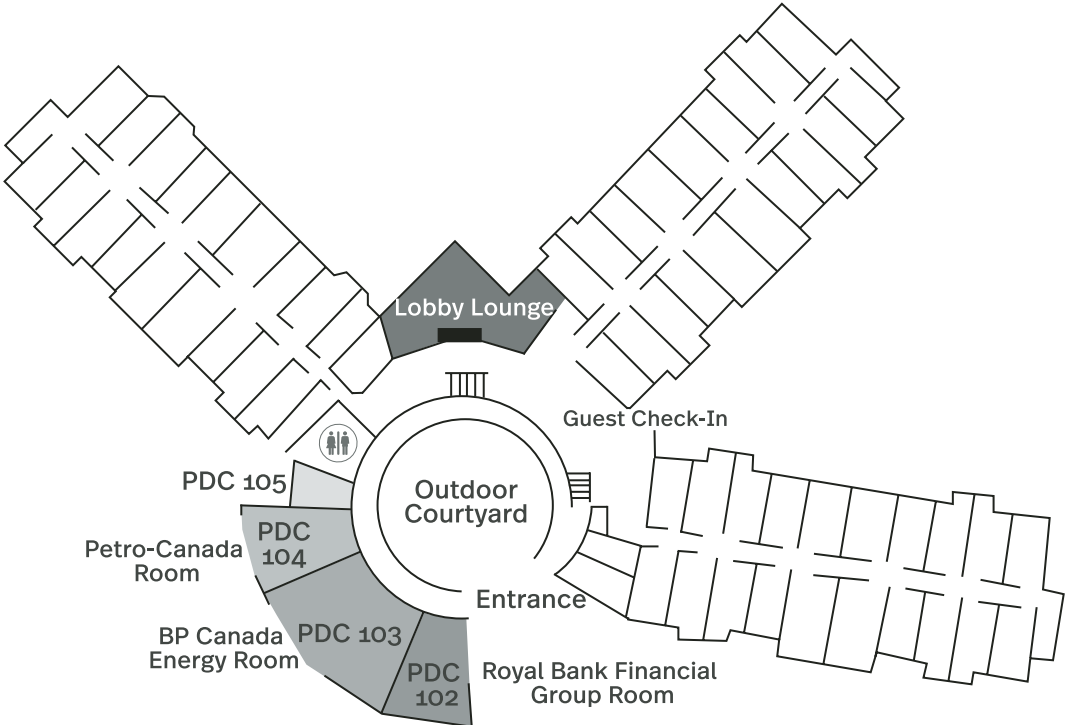

Photo by Chris Amat.

Professional Development Centre

Room Name and/or Number	Classroom (α / table)	Classroom (β / table)	Theatre	Rounds of 6	Rounds of 8	Rounds of 10	U-Shape	Boardroom	Hollow Square	Reception	Dimensions (metres) L x W	Dimensions (feet) L x W	Area (metres ²)	Area (feet ²)	Ceiling Height (metres)	Ceiling Height (feet)
Royal Bank Financial Group Room PDC 102	16	24	40	24	32	40	18	18	24	50	Irregular	Irregular	50	615	4.6 - 6.7	11 - 16
BP Canada Energy Room PDC 103	32	48	74	42	56	70	21	18	30	100	Irregular	Irregular	122	1,320	4.6 - 6.7	11 - 16
Petro-Canada Room PDC 104	16	24	40	24	32	40	18	18	24	50	Irregular	Irregular	50	615	4.6 - 6.7	11 - 16

Please Note: All capacity numbers are based on basic AV set-ups.







Theatre Complex

Jenny Belzberg Theatre

Banff Centre's largest theater (former: Eric Harvie Theatre) has undergone a major revitalization that improves audience experience and accessibility for delegates and attendants. The newly named Jenny Belzberg Theatre is best suited for presentation and lectures for up to 600 participants.

Margaret Greenham Theatre + Laszlo Funtek Teaching Wing

The neighbouring **Margaret Greenham Theatre** is an intimate performance space for plays, concerts, and dance theatre. Adjacent to this facility is the **Laszlo Funtek Teaching Wing** featuring dance studios and classrooms. **The Club** is an informal performance space designed in the spirit of an underground jazz club.

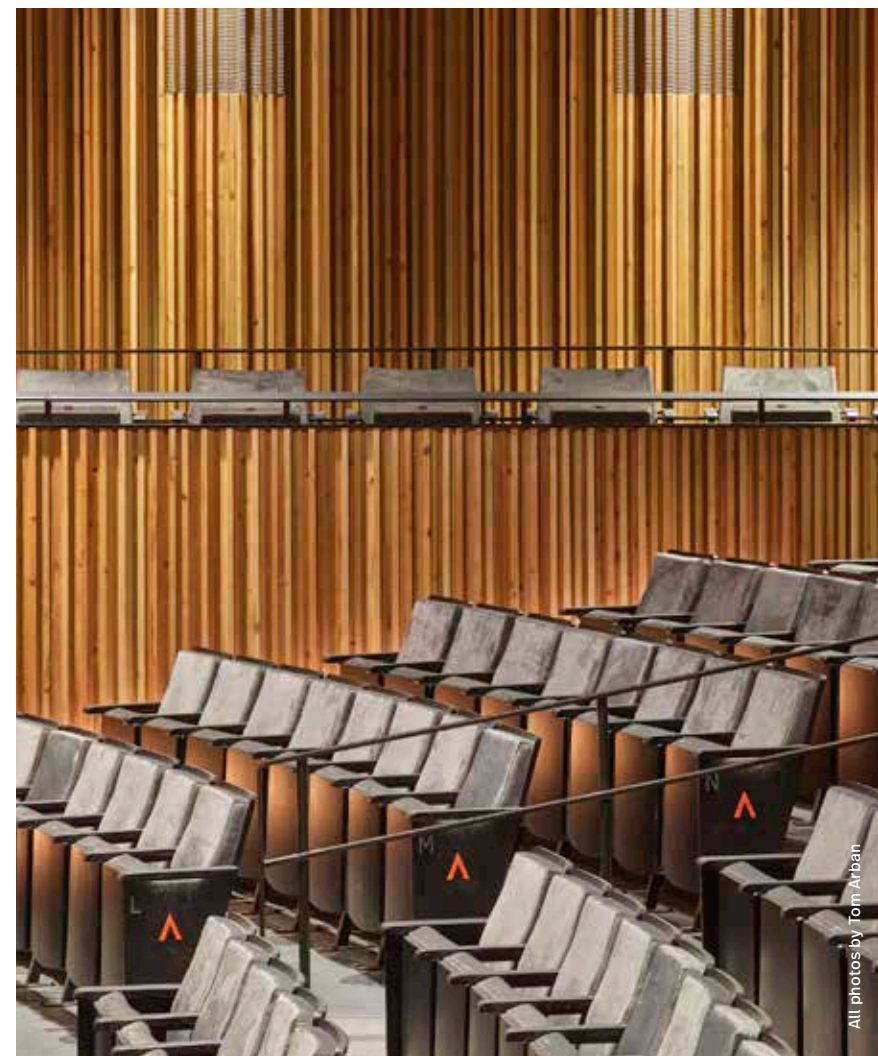

All photos by Tom Arban

Theatre Complex

Room Name and/or Number	Theatre	Classroom	U-Shape	U-Shape with inserts	Boardroom	Hollow Square	Rounds of 6	Reception	Dimensions (metres) L x W	Dimensions (feet) L x W	Area (metres ²)	Area (feet ²)	Ceiling Height (metres)	Ceiling Height (feet)
LF 117	40	14	9		14	14	12		7.3 x 6.4	24 x 21	47	504	2.7	8' 10"
LF 121	60	30	18	22	26	26	24		9.1 x 8.8	30 x 29	81	870	2.7	8' 10"
LF 122	60	40	24	32	24	24	30		13.6 x 14	45 x 46	190	2,052	2.2 - 2.9	7'4" - 9' 7"
LF 123	60	30	18	22	26	26	24		9.1 x 8.8	30 x 29	81	870	2.7	8' 10"
LF 124	60	40	24	32	24	24	30		13.6 x 14	45 x 46	190	2,052	2.2 - 2.9	7'4" - 9' 7"
LF 122 & 124	120	80	44	60	45	45	60		13.6 x 28	45 x 92	380	4,140	2.2 - 2.9	7'4" - 9' 7"
LF 217	24	10	6		10	8	6		4.1 x 6.1	13.5 x 20	25	270	2.7	8' 10"
LF 221	60	30	18	22	26	26	24		9.1 x 8.8	30 x 29	81	870	2.7	8' 10"
LF 223	60	30	18	22	26	26	24		9.1 x 8.8	30 x 29	81	870	2.7	8' 10"
Margaret Greenham Theatre *fixed seating	246								Irregular	Irregular		3,500	18	60
RBC Lobby - East	80							120	Irregular	Irregular	151	1,624	3.2	10' 7"
RBC Lobby								100	28.3 x 7.1	93 x 24	204	2,195	3.3	10' 9"
Jenny Belzberg Theatre * fixed seating	600								17.7 x 8.5	58 x 28		10,440	18	60
The Club								125	12 x 15.5	40 x 51	187	2,040		

Please Note: All capacity numbers are based on basic AV set-ups

A group of approximately 20 people are sitting in a circle on a grassy clearing in a forest of tall, thin evergreen trees. They appear to be in a discussion or a workshop session. The scene is bright and natural, with sunlight filtering through the trees.

Innovative programming

Banff Centre's inspiring location, unique artistic facilities, and transformative programming enable your attendees to realize their creative potential and achieve results.

Our Conference Connectors and Cultural Experiences are easily added to your agenda to enhance attendee experience and to support your goals. They feature creative, thought-provoking, entertaining sessions designed to foster relationships, engagement, and discovery.

“The team found the session to be very good, it is something new that we hadn’t tried before and proved to be much better than trying to accomplish the same goal in a boardroom. It challenged our thinking as a team and gave us some things to take away and reflect upon.”

Brody Mainville, Shell Canada Limited



Photo courtesy of Banff Centre.



Photo courtesy of Banff Centre.

Conference planning

In addition to our innovative programming, Banff Centre offers a variety of services to ensure your meetings run smoothly from start to finish. Our professional conference service staff are proficient in effective meeting room setups, menu and special event planning, conference technology and services, and other special needs.

- **Registration Packages.** Conference packages to assist with participant registration, registration kit preparation, final reporting, and more.
- **Technical Services.** In-house audiovisual and digital technology services and tools to deliver interactive and engaging meetings.
- **Additional Services.** Wi-fi, computers, faxing, and printing. For larger jobs, Banff Centre also has a print shop on campus.



Photo courtesy of Banff Centre.

Stay + Dine

Banff Centre Hotel

Located minutes away from downtown, Banff Centre hotel encompasses two buildings. Our 387 guest rooms and suites provide your delegates with a central location to easily access conference spaces, dining experiences, and recreational activities.

Newly renovated **Lloyd Hall** incorporates vertical cedar fins on the outside and white-oak paneling on the inside to nestle you into the mountains. The large and unobstructed windows are your gateway to spectacular mountains vistas. The hotel is a living gallery, with Banff Centre resident artists showcased extensively within the rooms.

The guest rooms at **Professional Development Centre** radiate warmth and comfort with fireplaces throughout the building. The hotel is designed with massive tree pillars and three wings that extend from a natural open courtyard. The lounges and meeting spaces are renowned for large windows and high vaulted ceilings that welcome in natural light.

Dining

Banquets and receptions

Banff Centre has everything you need to plan enticing dining choices for your event. Whether it's a hearty breakfast, a quick working lunch, or an elegant banquet, our flexible dining experiences are designed to delight your attendees and accommodate all dietary preferences. Our ingredients are regionally and sustainably sourced and prepared on-site by Banff Centre's award-winning culinary team.

Restaurants

Our three eateries and expert chefs will make sure that food is a highlight of your time with us. From a high-end restaurant to casual dining, and buffets, we cater to every appetite.



Photo courtesy of Banff Centre.



Photo by Tom Arban



Photo courtesy of Banff Centre.



Photo courtesy of Banff Centre.

Sally Borden Fitness and Recreation Centre

The Sally Borden Fitness and Recreation Centre offers full-service facilities to accommodate a wide range of fitness interests.

Swimming pool, hot tub,
steam rooms

Fitness room with weights
and cardio equipment

Climbing gym

Drop-in classes

Gymnasium

Running track

Spin studio

Massage



Photo courtesy of Banff Centre.



Photo courtesy of Banff Centre.

Arts + Culture

Banff Centre hosts over 400 performances, concerts, and festivals each year, including Banff Centre Mountain Film and Book Festival.

Free Open Lectures and Studios

Discover the work of artists in the Visual Arts programs by touring their studios, and attend talks by leading Canadian and international artists, curators, and academics.

Walter Phillips Gallery

Explore contemporary art exhibitions with a commitment to emerging forms of art, including video and performance.

Library

Explore Paul D. Fleck Library and Archives, featuring a unique and extensive book collection.

Banff Centre Mountain Film and Book Festival

Don't miss nine epic days of Banff Centre Mountain Film and Book Festival filled with stories of remote journeys and ground-breaking expeditions, including ticketed and free events.

Banff Centre International String Quartet Competition

Banff Centre International String Quartet Competition celebrates the art of chamber music while providing career support for emerging string quartets.

National Indigenous Peoples Day

Join us in celebrating arts and culture with the Indigenous peoples of Canada at Banff Centre.



Photo courtesy of Banff Centre.

The Destination

Banff National Park is one of the world's most beautiful natural areas. Conference attendees at Banff Centre have a unique opportunity to spend time in the national park, enjoy the breathtaking scenery, and experience the destination with year-round activities on their own or with the help of our industry partners.

SUMMER AND FALL

golfing • cycle tours • guided hiking
boat tours • heli-tours and heli-
hiking • rock climbing • horseback
riding • river rafting • gondola and
chairlift rides • guided fishing trips •
kayaking • bus tours • canoeing

WINTER AND SPRING

skiing: downhill, cross-country,
telemark, and heli-skiing • skating •
heli-tours • bus tours • snowshoeing
• tobogganing • sleigh rides •
snowboarding • gondola and
chairlift rides



Hiking Larch Valley. Photo by Devaan Ingraham.

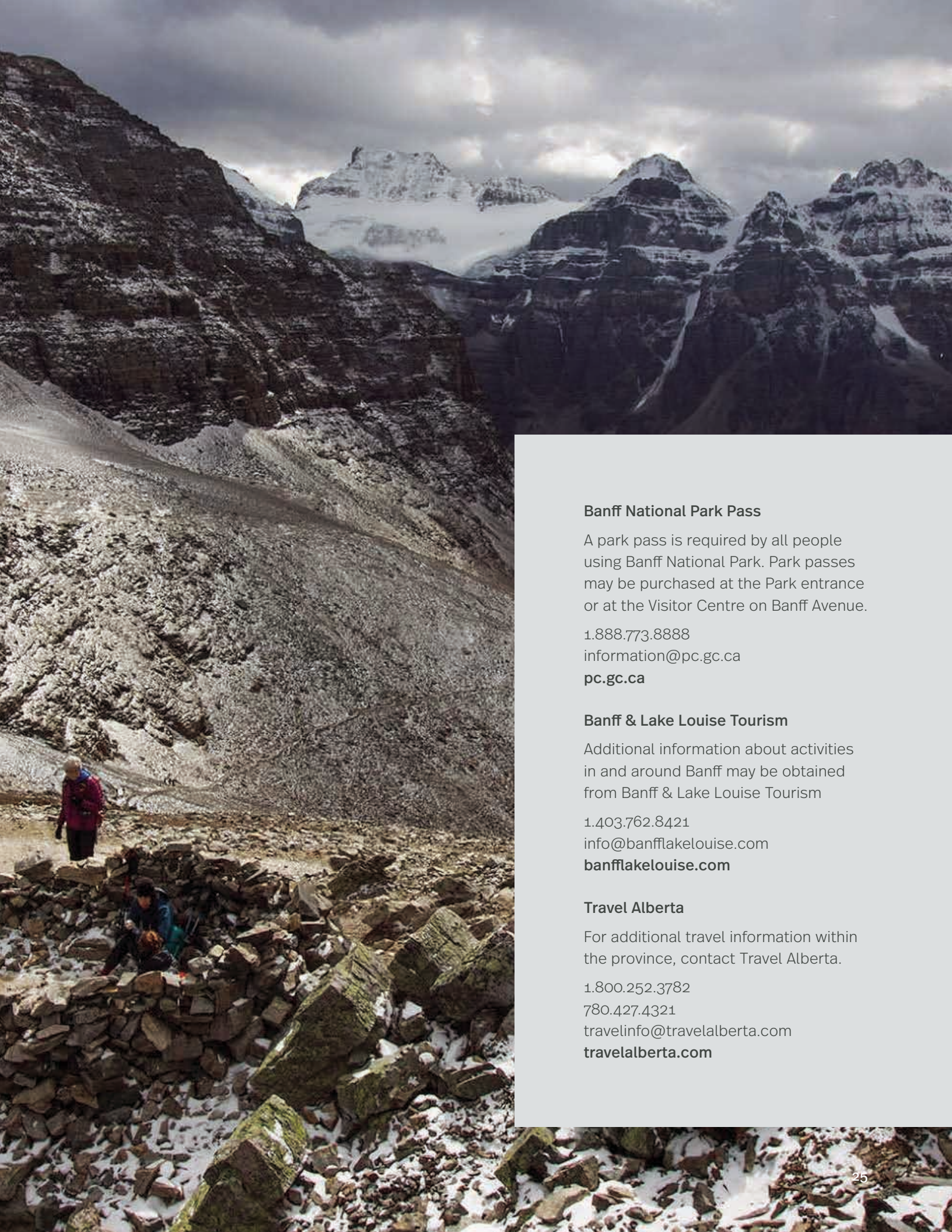

Banff National Park Pass

A park pass is required by all people using Banff National Park. Park passes may be purchased at the Park entrance or at the Visitor Centre on Banff Avenue.

1.888.773.8888
information@pc.gc.ca
pc.gc.ca

Banff & Lake Louise Tourism

Additional information about activities in and around Banff may be obtained from Banff & Lake Louise Tourism

1.403.762.8421
info@banfflakelouise.com
banfflakelouise.com

Travel Alberta

For additional travel information within the province, contact Travel Alberta.

1.800.252.3782
780.427.4321
travelinfo@travelalberta.com
travelalberta.com

General information

Banff Centre

107 Tunnel Mountain Drive
Box 1020, Banff, Alberta T1L 1H5
403.762.6100
banffcentre.ca

Main Switchboard

403.762.6100 (open 24 hours)
403.762.6444

Conference Office

Box 1020, Banff, Alberta
Canada T1L 1H5
1.877.760.4595
403.763.6712
Fax: 403.762.6202
conferences@banffcentre.ca

Guest Room Reservations

1.800.884.7574
403.762.6308
Fax: 403.762.7502
reservations@banffcentre.ca

Box Office

1.800.413.8368
403.762.6301
Fax: 403.762.6483
box_office@banffcentre.ca

Getting Here

Banff is easily accessible from all main centres in Alberta via major highways. The Calgary International Airport is located 130 km (80 miles) from Banff and services daily flights from most major centres around the world. Motor coach service is available directly from the airport or downtown Calgary. Major car rental companies are located at the Calgary International Airport and in Banff. For local transportation, taxi service or local transit is available in Banff.

Approximate driving times:

From Calgary, AB – 1.5 hrs (130 km / 80 miles)

From Edmonton, AB – 4 hrs (415 km / 255 miles).

Banff Airporter

Official airport shuttle of Banff Centre
1.888.449.2901 | 403.762.3330
info@banffairporter.com
banffairporter.com

Wheelchair Access

There are paths, roadways or ramps that provide access to and throughout most buildings. However, the Centre, built on the side of a mountain, does present challenges to those with limited mobility. Wheelchair access points for Banff Centre buildings are indicated on our property map. The Centre has a limited number of bedrooms which have been adapted for wheelchair access; advanced booking is required.

If you or any of your delegates have special needs, please contact your conference services manager in advance of your stay so that we can provide assistance to make your stay more comfortable.

Pets

Please note only service animals are allowed at Banff Centre.

Non Smoking Policy

For the health, safety, and comfort of our guests, Banff Centre is a smoke-free facility. Smoking is permitted only in Banff Centre's designated outdoor smoking areas.

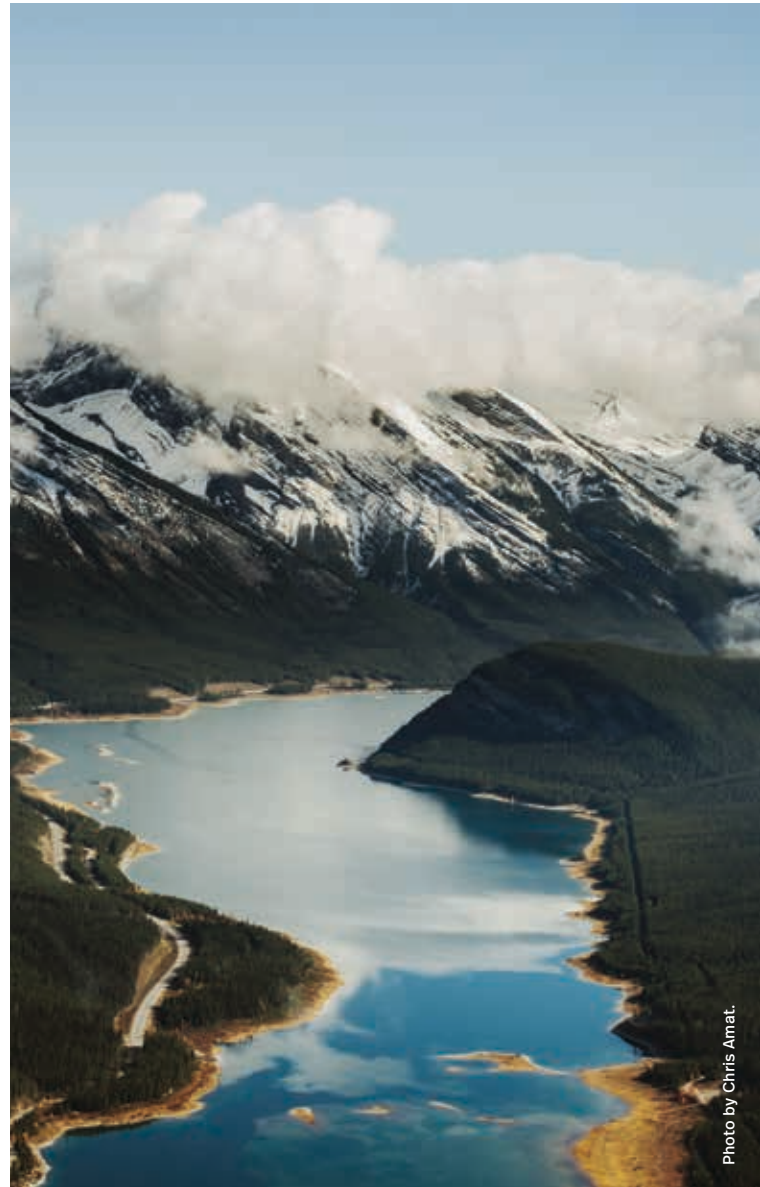

Photo by Chris Amat.

Environmental Leadership

Banff Centre is committed to environmental leadership and performance in all its operations and has developed and implemented a wide range of environmental initiatives.

Current environmental ratings:

- Green Leaf 4-leaf property rating
- Hotel Association of Canada Green Key 4-key environmental rating
- IAAC Green Star – Platinum rating

Some examples of Banff Centre environmental best practices include:

- organic waste composting
- recycling
- water conservation practices
- hazardous materials disposal
- natural vegetation landscaping
- use of an electric maintenance vehicle and bio-diesel fuel
- incorporating LEED Green Building Rating System® standards into new building construction



International Association of Conference Centres

Banff Centre is a member of the International Association of Conference Centres (IACC), the global thought leader on the meeting experience. IACC certification is a badge of excellence and a guarantee that we adhere to stringent service and quality criteria designed to ensure the success of every meeting. Banff Centre is the only IACC certified conference facility in Western Canada. iacconline.org.

The Centre complies with IACC's exacting standards for conference centres ensuring that meeting planners and their organizations are

provided with all the essential components for a successful event. Conference centres specialize in meetings, and provide professional meeting spaces and services designed to offer the highest standards in meeting facilities, services, and technologies. Conference centres provide a business-friendly structure and support system tailored to help organizations achieve their meeting goals. Further information on the IACC conference centre difference is available at iacconline.org. Banff Centre is the only IACC certified conference facility in Alberta, and one of only two in Western Canada.

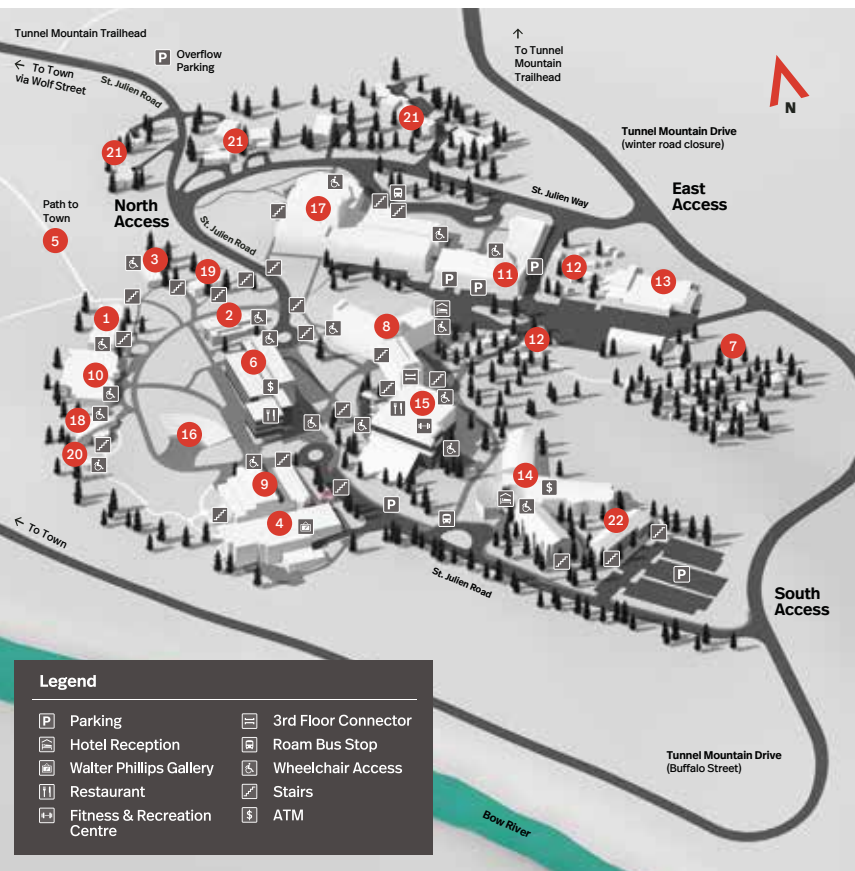

- | | |
|---|---|
| 1 Corbett Hall | 13 Physical Facilities Building
Print Shop
Shipping & Receiving |
| 2 Donald Cameron Centre
Administration Offices | 14 Professional Development Centre
Hotel Reception |
| 3 Farrally Hall | 15 Sally Borden Building
Fitness & Recreation Centre
Participant Resources
Three Ravens Restaurant
Vistas Dining Room |
| 4 Glyde Hall
Walter Phillips Gallery | 16 Shaw Amphitheatre |
| 5 Ken Madsen Path to Town | 17 Theatre Complex
Box Office
Eric Harvie Theatre
Laszlo Funtek Teaching Wing
Margaret Greenham Theatre
The Club |
| 6 Kinnear Centre for Creativity & Innovation
Maclab Bistro
Meeting Rooms & Banquets
Paul D. Fleck Library & Archives | 18 TransCanada PipeLines Pavilion
Banff International Research Station |
| 7 Leighton Artists Studios | 19 Vinci Hall |
| 8 Lloyd Hall
Hotel Reception | 20 Yurt |
| 9 Jeanne & Peter Loughheed Building | 21 Staff Housing |
| 10 Max Bell Building | 22 Staff Housing
Becker Hall |

Services at Banff Centre

Vistas Dining Room Breakfast 7:00 a.m. – 9:30 a.m. Lunch 11:30 a.m. – 1:30 p.m. Dinner 5:30 p.m. – 7:30 p.m.	Le Café 10:00 a.m. – 10:00 p.m.	Paul D. Fleck Library & Archives Monday – Thursday 9:00 a.m. – 8:00 p.m. Friday 9:00 a.m. – 6:00 p.m. Saturday CLOSED Sunday 11:00 a.m. – 7:00 p.m.
Three Ravens Restaurant 5:00 p.m. – 9:00 p.m.	Maclab Bistro 7:00 a.m. – 2:00 a.m.	Office of the Registrar Monday – Friday 8:30 p.m. – 4:30 p.m. Professional Development Centre (PDC) 201 and 202
Three Ravens Wine Bar 4:00 p.m. – 12:00 p.m.	Walter Phillips Gallery Wednesday – Sunday 12:30 p.m. – 5:00 p.m.	
	Box Office 12:00 p.m. – 5:00 p.m.	





Photo by Karl Medig.



Photo by Tom Arban Photography Inc.

Contact us

Conferences at Banff Centre
for Arts and Creativity
Box 1020, Banff, Alberta, Canada T1L 1H5
1.877.760.4595 | 403.763.6712
conferences@banffcentre.ca
banffcentre.ca/conferences

Follow us on



BANFF
CENTRE
FOR ARTS AND
CREATIVITY